

**South Woods Building 600**  
**73 South Woods Parkway**  
**15,947 SF Available**  
**Atlanta South Submarket**

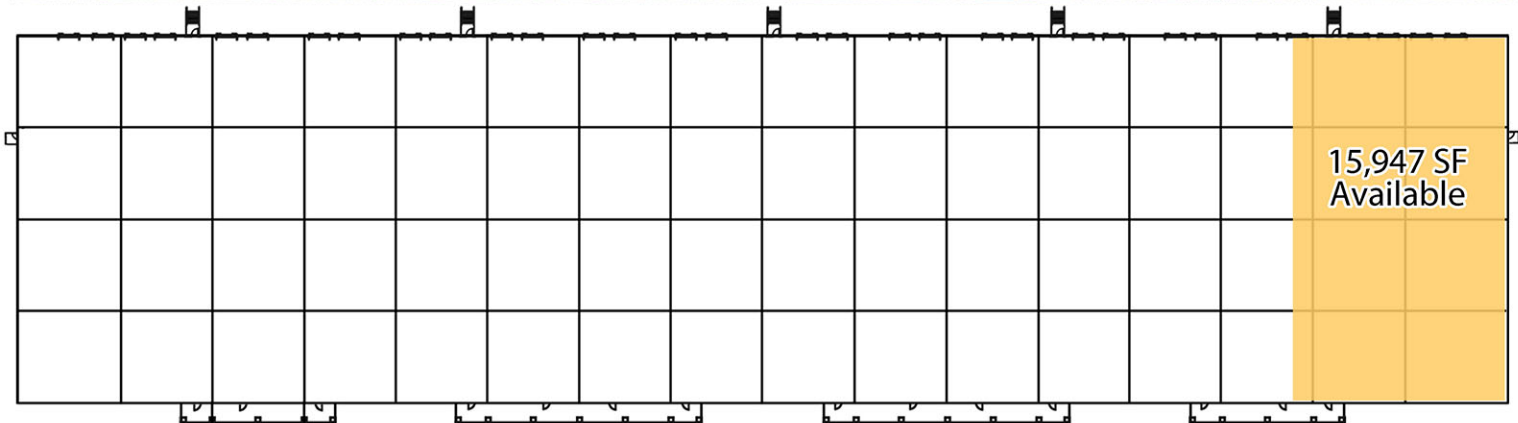

**Building 600: Suite 150 / 15,947 SF Available**

- 15,947 SF available with 5 dock doors, 1 ramp door
- 3,429 SF Office
- 24' clear height
- Ample parking
- Updated lighting to T5
- Fully sprinklered
- 3-phase, 277/480 volt power
- Architecturally designed site cast concrete
- Truck court - 130' deep
- White box warehouse walls



**TAYLOR&MATHIS**  
 www.TaylorMathis.com

Contact: Walker Wellford [wwellford@taylormathis.com](mailto:wwellford@taylormathis.com) Hamilton Reynolds [hreynolds@taylormathis.com](mailto:hreynolds@taylormathis.com)  
 Taylor & Mathis ♦ 400 Interstate North Parkway ♦ Suite 850 ♦ Atlanta, GA 30339 ♦ 770.795.1330

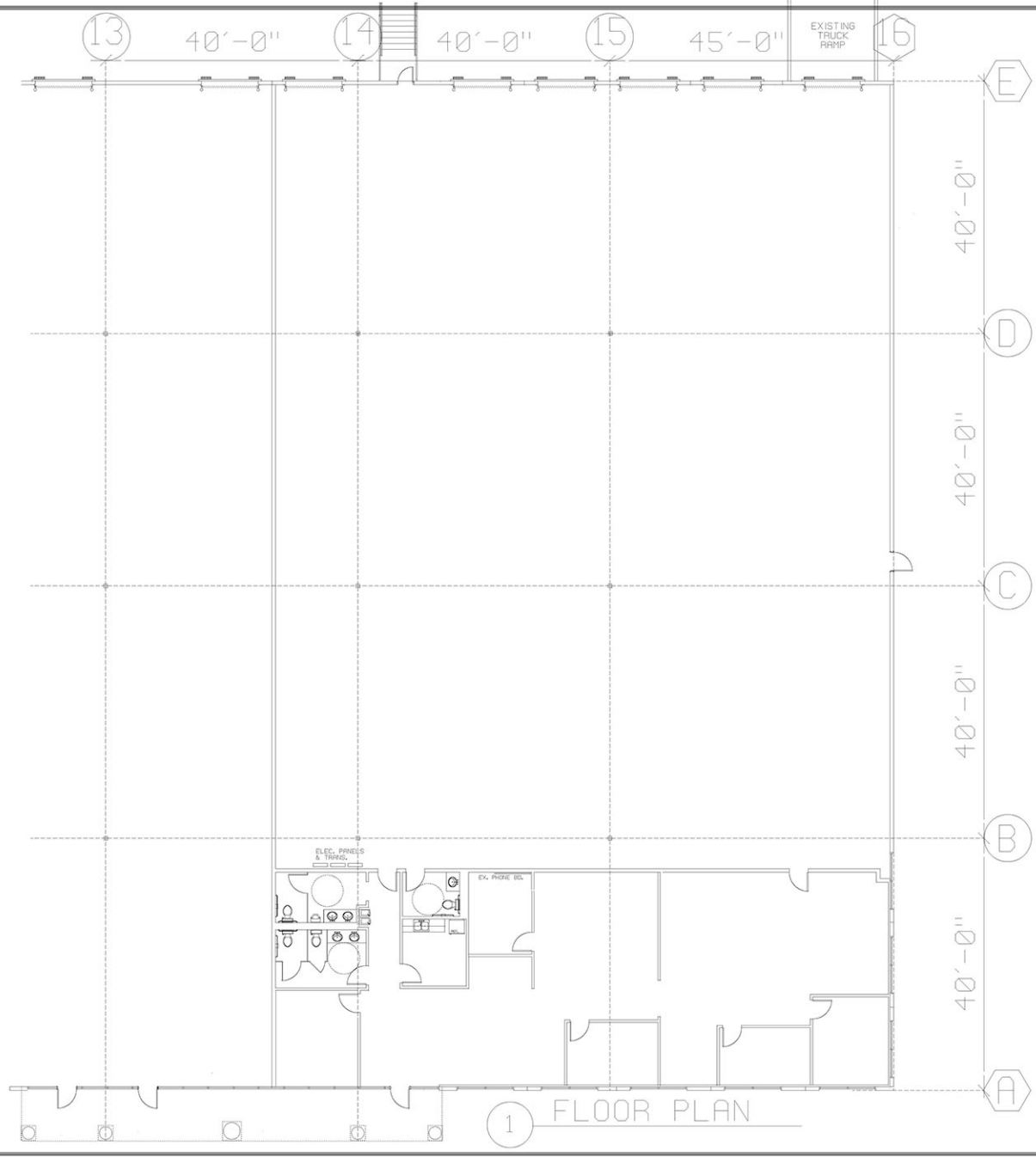

1 FLOOR PLAN

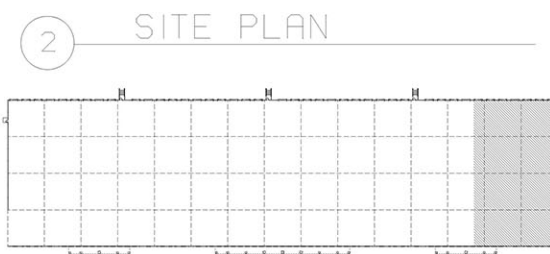

2 SITE PLAN

3,429 OFFICE SQUARE FEET  
 12,518 WHSE SQUARE FEET  
 15,947 TOTAL SQUARE FEET

TAYLOR & MATTHEW			
<small>Architectural Firm        1400 Peachtree Street, N.E.        Atlanta, Georgia 30309        404.525.8888        404.525.8888 Fax</small>			
Revision:			
Scale:	Date:	Drawn By:	Checked By:
1/8" = 1'-0"	APRIL 18, 2022	FSAMES	
73 SOUTH WOODS PARKWAY, BLDG 600, SUITE 140 & 150, GEORGIA			
 <b>Castle Design</b>			
<small>08107 Castle        2017, All rights reserved        ATLANTA, GEORGIA        30303        404.525.8888        404.525.8888        www.cd_design.com        info@castledesign.com</small>			
Drawing Number:			
A-1			
JOB NO.:			
A/E Job Number:			